

# Data sheet

Sheet No.: A1.101.30 Rev. B  
Date: January 2012

## CONSTRUCTION, PARTS AND MATERIALS P-SERIES ACTUATORS

P

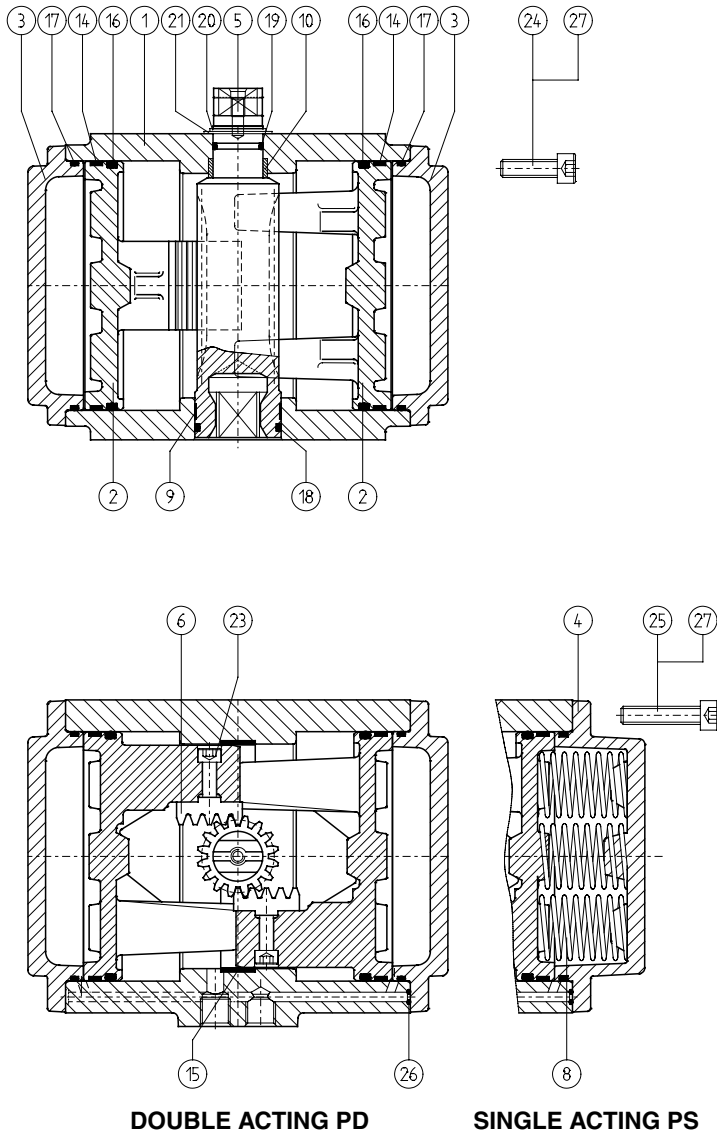

Parts			Materials		Executions		
Nr.	Description	Qty.	Description	Specification	Std	S.S. Shaft	CSR
1	Body	1	Aluminum Alloy	UNS A13600, ASTM B85	-	-	6
2	Piston	2	Aluminum Alloy	UNS A03560, ASTM B26	-	-	-
3	Endcap PDA	2	Aluminum Alloy	UNS A13600, ASTM B85	-	-	6
4	Endcap PSA	2	Aluminum Alloy	UNS A13600, ASTM B85	-	-	6
5	Drive pinion	1	Aluminum Alloy	UNS 1 77075, ASTM 7075 T6	1	4	4
6	Gear Rack	2	Steel	UNS G10950, ASTM A108	-	-	-
8	Spring	14	Carbon Spring Steel	UNS G10860, ASTM A228	2	2	2
9	* Bearing Bush	1	Nylatron GS	PA6.6 + MoS2	-	-	-
10	* Bearing Bush	1	Delrin	POM	-	-	-
14	* Guide band	2	PTFE, Carbon filled	PTFE + 25% C	-	-	-
15	* Guide band	2	PTFE, Carbon filled	PTFE + 25% C	-	-	-
16	* O-ring	2	Nitrile Rubber	Buna N	-	-	-
17	* O-ring	2	Nitrile Rubber	Buna N	-	-	-
18	* O-ring	1	Nitrile Rubber	Buna N	-	-	-
19	* O-ring	1	Nitrile Rubber	Buna N	-	-	-
20	* Spring Clip	1	Carbon Spring Steel	MIL - R-212 48B	2	5	5
21	* Thrust Washer	1	ZEDEX 100 K	-	-	-	-
23	Bolt	4	Alloy Steel	12.9 ASTM F568	-	-	-
24	Endcap bolt PDA	20	Alloy Steel	8.8 ASTM F568	2	4	4
25	Endcap bolt PSA	20	Alloy Steel	8.8 ASTM F568	2	4	4
26	* O-ring	2	Nitrile Rubber	Buna N	-	-	-
27	Threaded insert	20	Steel	UNS G10430, ASTM A29	3	3	3

\* Recommended spare parts (contained in Repair kit)

### Notes

- 1 Hard anodized
- 2 Deltatone® Coating
- 3 Zinc plated and passivated
- 4 Stainless Steel AISI 304
- 5 Stainless Steel, X35CrM017
- 6 CSR Coating (see A4.204.02)
- 7 P4000 has a stainless steel (AISI 304) locking ring between spring clip (20) and thrust washer (21)
- 8 P4000 has in the springs a guiding bush (PVC)

### Remark

All materials are European origin, listed are the nearest US equivalents

### Finish

- Standard : Polyester non-TGIC based powder coating (see data sheet A4.204.01)
- CSR : CSR Coating (see data sheet A4.204.02)

**EL-O-MATIC™**

www.El-O-matic.com

Copyright © Emerson Process Management. The information in this document is subject to change without notice.

Updated data sheets can be obtained from our website [www.El-O-Matic.com](http://www.El-O-Matic.com) or from your nearest Valve Automation Center **USA:** +1 813 319 0266 **Europe:** +31 74 256 10 10 **Asia-Pacific:** +65 6501 4600



**EMERSON™**  
Process Management