

4

3

2

1

REVISIONS				
REV	DESCRIPTION	ECO NO.	APP'D	DATE
AF	REVISE TO SHOW LAY LENGTH FOR BOTH PTFE, ETFE LINERS	RTC1026980	S.B.R.	10/14/08

**STANDARD WAFER MAGMETER
.15" TO 1"**

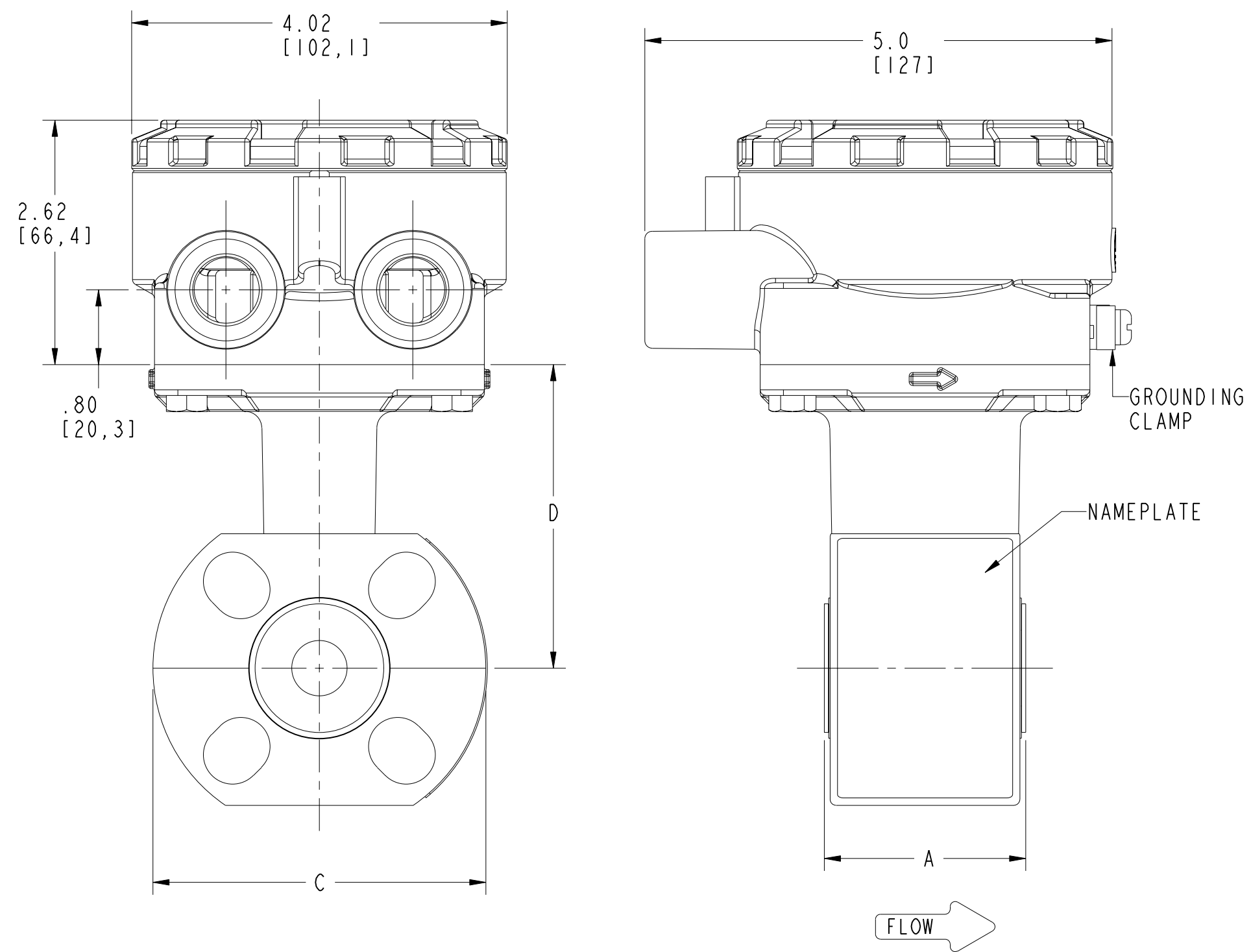

**STANDARD WAFER MAGMETER
1.5" TO 8"**

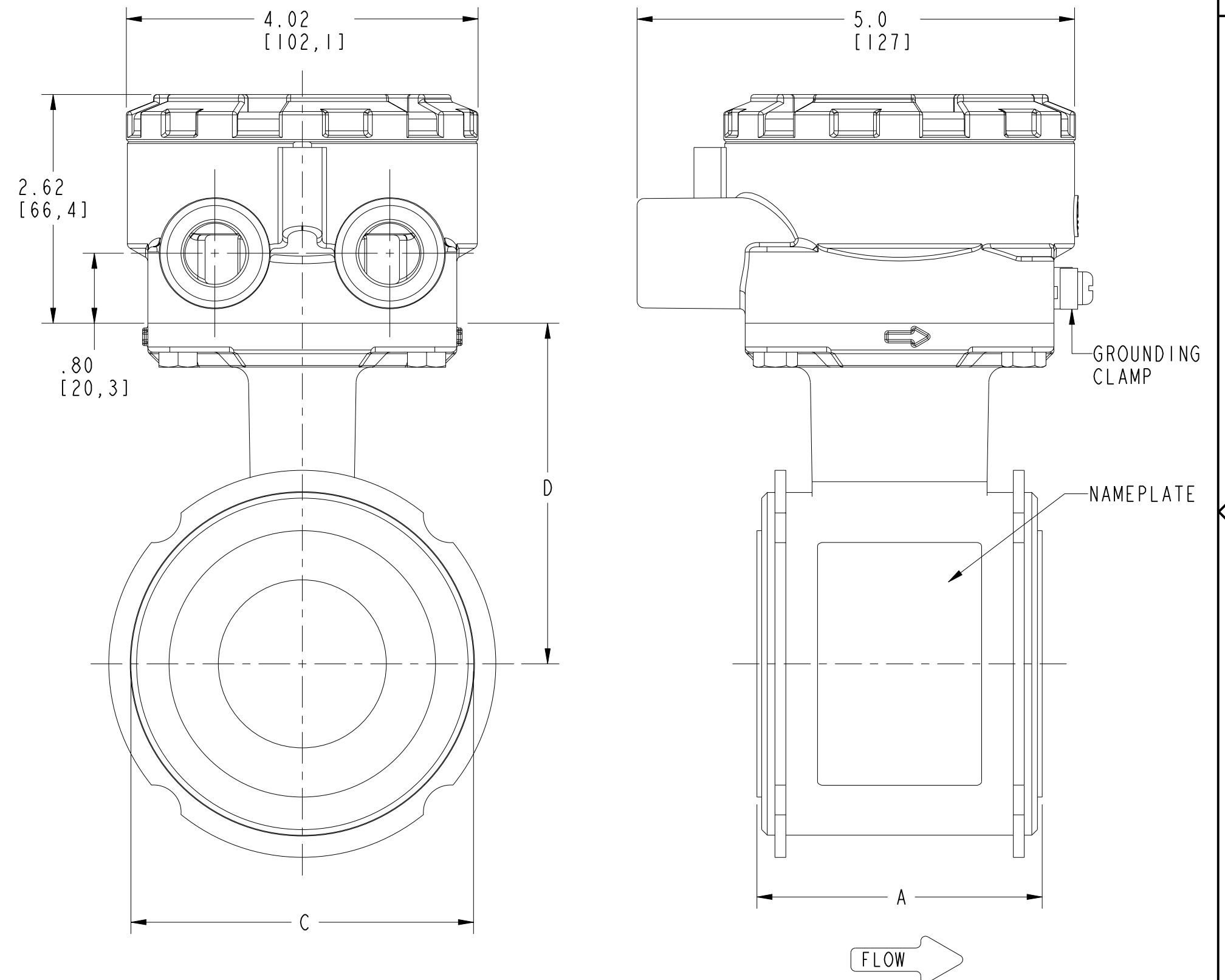

2. ROSEMOUNT INC. CERTIFIES THESE DRAWINGS ARE IN ACCORDANCE WITH ROSEMOUNT ENGINEERING SPECIFICATIONS AND ACCURATELY REPRESENTS THE EQUIPMENT FURNISHED.

1. ADD .25 [6, 4] TO TUBE LENGTH WHEN GROUNDING RINGS OR LINING PROTECTORS ARE ATTACHED.

CONFIDENTIAL AND PROPRIETARY INFORMATION IS CONTAINED HEREIN AND MUST BE HANDLED ACCORDINGLY.	UNLESS OTHERWISE SPECIFIED DIMENSIONS IN INCHES (mm). REMOVE ALL BURRS AND SHARP EDGES. MACHINE SURFACE FINISH 125				 8200 Market Boulevard Chanhassen, MN 55317 USA	
	-TOLERANCES- .X ± .1 [2,5] .XX ± .02 [0,5] .XXX ± .010 [0,25]		TITLE OUTLINE INSTALLATION DRAWING MODEL 8711 0.15"-8" WAFER FLOWTUBES			
	FRACTIONS ± 1/32 ANGLES ± 2° DO NOT SCALE PRINT		DR. D. BROKKE APP'D S. ROGERS	10/13/08 10/14/08	SIZE C DRAWING NO. 08711-3001	REV AF

Electronic Master - PRINTED COPIES ARE UNCONTROLLED - Rosemount Prohibited

B

A

4

3



2

1

TABLE 1 -- inch

Size, Description	Model Number	OVERALL LENGTH			Body Ø DIM "C"	CL to UMB DIM "D"	Flow Tube Weight (lbs.)
		DIM "A" PTFE	DIM "A" ETFE	DIM "A" PFA			
0.15 (4) WAFER UP TO ANSI - 150# / DIN PN16	8711_ _ _ 15F			2.17	3.56	3.25	4
0.3 (8) WAFER UP TO ANSI - 150# / DIN PN16	8711_ _ _ 30F			2.17	3.56	3.25	4
0.5 (15) WAFER UP TO ANSI - 300# / DIN PN40	8711_ _ _ 005	2.21	2.16		3.56	3.25	4
1 (25) WAFER UP TO ANSI - 300# / DIN PN40	8711_ _ _ 010	2.26	2.13		4.50	3.56	5
1.5 (40) WAFER UP TO ANSI - 300# / DIN PN40	8711_ _ _ 015	2.88	2.73		3.29	3.67	5
2 (20) WAFER UP TO ANSI - 300# / DIN PN40	8711_ _ _ 020	3.32	3.26		3.92	3.89	7
3 (80) WAFER UP TO ANSI - 300# / DIN PN40	8711_ _ _ 030	4.71	4.62		5.17	4.51	13
4 (100) WAFER UP TO ANSI - 300# / DIN PN40	8711_ _ _ 040	5.87	5.83		6.39	5.12	22
6 (150) WAFER UP TO ANSI - 300# / DIN PN40	8711_ _ _ 060	7.08	6.87		8.57	6.22	35
8 (200) WAFER UP TO ANSI - 300# / DIN PN40	8711_ _ _ 080	9.06	8.86		10.63	7.25	60

TABLE 1 -- millimeter

Size, Description	Model Number	OVERALL LENGTH			Body Ø DIM "C"	CL to UMB DIM "D"	Flow Tube Weight (kg)
		DIM "A" PTFE	DIM "A" ETFE	DIM "A" PFA			
0.15 (4) WAFER UP TO ANSI - 150# / DIN PN16	8711_ _ _ 15F			55	90	83	1.8
0.3 (8) WAFER UP TO ANSI - 150# / DIN PN16	8711_ _ _ 30F			55	90	83	1.8
0.5 (15) WAFER UP TO ANSI - 300# / DIN PN40	8711_ _ _ 005	56	55		90	83	1.8
1 (25) WAFER UP TO ANSI - 300# / DIN PN40	8711_ _ _ 010	57	54		114	90	2.3
1.5 (40) WAFER UP TO ANSI - 300# / DIN PN40	8711_ _ _ 015	73	69		84	93	2.3
2 (20) WAFER UP TO ANSI - 300# / DIN PN40	8711_ _ _ 020	84	83		99	99	3.2
3 (80) WAFER UP TO ANSI - 300# / DIN PN40	8711_ _ _ 030	120	117		131	115	5.9
4 (100) WAFER UP TO ANSI - 300# / DIN PN40	8711_ _ _ 040	149	148		162	130	10.0
6 (150) WAFER UP TO ANSI - 300# / DIN PN40	8711_ _ _ 060	180	174		218	158	15.9
8 (200) WAFER UP TO ANSI - 300# / DIN PN40	8711_ _ _ 080	230	225		270	184	27.2

B

A