

8

7

6

5

↓

4

3

2

1

TABULATION	
DASH NO.	

REVISIONS				
REV	DESCRIPTION	ECO NO.	APP'D	DATE
AB	ADD DIMENSION TABLES	RTC1027597		

**3" THRU 36"**  
SLIP-ON FLANGES

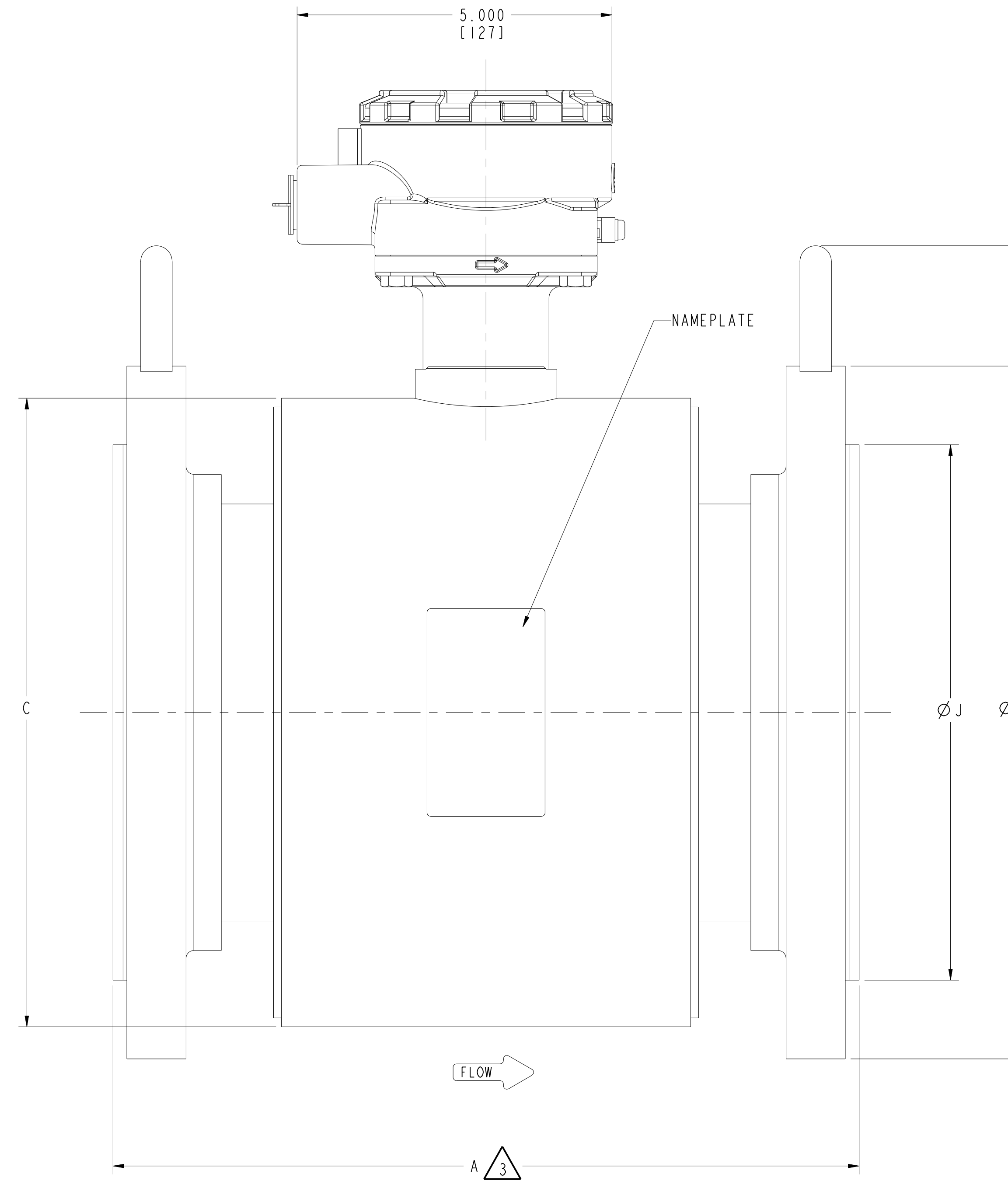
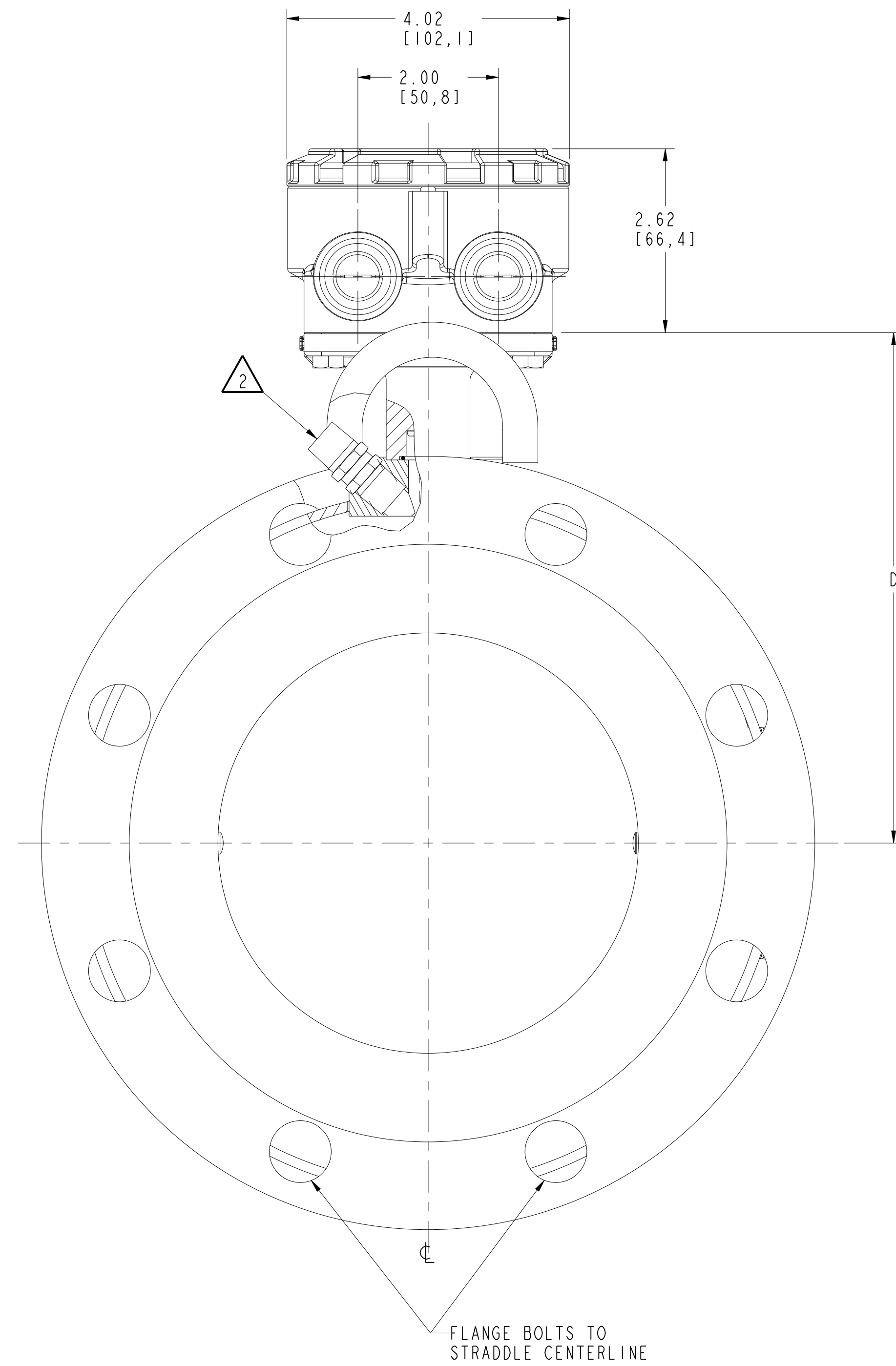

3 IF USING LINING PROTECTORS, SEE "LINING PROTECTOR" SHEET.  
IF USING GROUND RINGS, SEE "GROUND RING" SHEET.

2 PRESSURE RELIEF VALVE AVAILABLE WITH SEALED WELDED HOUSING (WI OPTION) ONLY.

1. ROSEMOUNT CERTIFIES THAT THIS DRAWING IS IN ACCORDANCE WITH ROSEMOUNT ENGINEERING SPECIFICATIONS AND ACCURATELY REPRESENTS THE EQUIPMENT FURNISHED.

<small>UNLESS OTHERWISE SPECIFIED DIMENSIONS IN INCHES (mm). REMOVE ALL BURRS AND SHARP EDGES. MACHINE SURFACE FINISH 125</small>	<small>EMERSON</small> <b>ROSEMOUNT</b> <small>Process Management</small> 8200 Market Boulevard Chanhassen, MN 55317 USA		
	TITLE <b>DIMENSIONAL DRAWING</b> <b>MODEL 8707 HIGH SIGNAL MAGNETIC FLOWTUBE</b>		
	<small>DR.</small> D. BROKKE 11/3/08	<small>SIZE</small> D	<small>DRAWING NO.</small> 08707-0022
	<small>APP'D</small> S. ROGERS 12/18/08	<small>REV</small> AB	<small>SHEET</small> 1 OF 3

1000000

8

7

6

5

4

3

2

1

TABLE 1 -- inch

Size, Description	Model Number	OVERALL LENGTH						Body Ø DIM "C"	CL to UMB DIM "D"	Liner Ø on Face DIM "J"	Lift Ring Height DIM "K"	Flow Tube Weight (lbs.)
		DIM "A" PTFE	DIM "A" ETFE	DIM "A" Neoprene	DIM "A" Linatex	DIM "A" Poly	DIM "A" PFA					
3 (80) ANSI - 150#, SO / RF	8707 ___ 030C1	7.87	7.87	7.86	7.87	7.87		7.21	5.82	5.00	1.70	42
3 (80) ANSI - 300#, SO / RF	8707 ___ 030C3	8.63	8.63	8.61	8.62	8.63	8.63	7.21	5.82	5.00	1.70	47
4 (100) ANSI - 150#, SO / RF	8707 ___ 040C1	9.84	9.84	9.83	9.84	9.84	9.84	7.91	6.17	6.19	1.70	57
4 (100) ANSI - 300#, SO / RF	8707 ___ 040C3	10.88	10.88	10.86	10.87	10.88	10.88	7.91	6.17	6.19	1.70	65
6 (150) ANSI - 150#, SO / RF	8707 ___ 060C1	11.81	11.81	11.78	11.79	11.83	11.81	9.98	7.30	8.50	1.70	71
6 (150) ANSI - 300#, SO / RF	8707 ___ 060C3	13.06	13.06	13.03	13.04	13.08	13.06	9.98	7.30	8.50	1.70	93
8 (200) ANSI - 150#, SO / RF	8707 ___ 080C1	13.78	13.78	13.72	13.81	13.77	13.78	11.92	8.27	10.62	1.70	145
8 (200) ANSI - 300#, SO / RF	8707 ___ 080C3	15.60	15.60	15.53	15.54	15.58	15.60	11.92	8.27	10.62	1.70	162
10 (250) ANSI - 150#, SO / RF	8707 ___ 100C1	15.00	14.90	14.75	14.76	14.80	15.00	14.64	9.69	12.75	2.00	195
10 (250) ANSI - 300#, SO / RF	8707 ___ 100C3	17.13	17.03	16.88	16.89	16.93	17.13	14.64	9.69	12.75	2.00	300
12 (300) ANSI - 150#, SO / RF	8707 ___ 120C1	18.00	17.90	17.87	17.76	17.80	18.00	16.80	10.77	15.00	2.00	330
12 (300) ANSI - 300#, SO / RF	8707 ___ 120C3	20.14	20.03	20.00	19.89	19.93	20.14	16.80	10.77	15.00	2.00	435
14 (350) ANSI - 150#, SO / RF	8707 ___ 140C1	20.91	20.93	20.90	20.79	20.83	21.00	18.92	11.83	16.25	2.00	380
14 (350) ANSI - 300#, SO / RF	8707 ___ 140C3	23.16	23.18	23.15	23.04	23.08	23.25	18.92	11.83	16.25	2.00	573
16 (400) ANSI - 150#, SO / RF	8707 ___ 160C1	23.88	23.90	23.87	23.76	23.80		20.94	12.84	18.50	3.13	470
16 (400) ANSI - 300#, SO / RF	8707 ___ 160C3	26.13	26.15	26.12	26.01	26.05		20.94	12.84	18.50	3.13	755
18 (450) ANSI - 150#, SO / RF	8707 ___ 180C1	26.85	26.87	26.84	26.73	26.77		23.46	14.10	21.00	3.13	592
18 (450) ANSI - 300#, SO / RF	8707 ___ 180C3	29.97	30.00	29.96	29.85	29.89		23.46	14.10	21.00	3.13	1010
20 (500) ANSI - 150#, SO / RF	8707 ___ 200C1	29.78	29.80	29.77	29.66	29.70		25.48	15.11	23.00	3.13	680
20 (500) ANSI - 300#, SO / RF	8707 ___ 200C3	33.04	33.08	33.03	32.92	32.96		25.48	15.11	23.00	3.13	1180
24 (600) ANSI - 150#, SO / RF	8707 ___ 240C1	35.75	35.77	35.87	35.63	35.67		30.03	17.39	27.25	3.13	1020
24 (600) ANSI - 300#, SO / RF	8707 ___ 240C3	39.38	39.40	39.50	39.26	39.30		30.03	17.39	27.25	3.13	1865
30 (750) AWWA CLASS D, SO / FF	8707 ___ 300C1	37.00	37.03	37.13	36.89	36.93		35.50	20.13	33.75	3.13	1400
30 (750) MSS SP44 - 150#, SO / RF	8707 ___ 300C2	41.56	41.58		41.44	41.48		35.50	20.13	33.75	3.13	1782
30 (750) MSS SP44 - 300#, SO / RF	8707 ___ 300C3	47.25	47.27		47.13	47.17		35.50	20.13	33.75	3.13	2610
36 (900) AWWA CLASS D, SO / FF	8707 ___ 360C1	40.63	40.65	40.75	40.51	40.55		43.37	24.00	40.25	3.13	1975
36 (900) MSS SP44 - 150#, SO / RF	8707 ___ 360C2	47.25	47.27		47.13	47.17		43.37	24.00	40.25	3.13	2777
36 (900) MSS SP44 - 300#, SO / RF	8707 ___ 360C3	53.17	53.19		53.05	53.09		43.37	24.00	40.25	3.38	4204

TABLE 1 - millimeter

Size, Description	Model Number	OVERALL LENGTH						Body Ø DIM "C"	CL to UMB DIM "D"	Liner Ø on Face DIM "J"	Lift Ring Height DIM "K"	Flow Tube Weight (kg)
		DIM "A" PTFE	DIM "A" ETFE	DIM "A" Neoprene	DIM "A" Linatex	DIM "A" Poly	DIM "A" PFA					
3 (80) ANSI - 150#, SO / RF	8707 ___ 030C1	200	200	200	200	200		183	148	127	43	19.1
3 (80) ANSI - 300#, SO / RF	8707 ___ 030C3	219	219	219	219	219	219	183	148	127	43	21.3
4 (100) ANSI - 150#, SO / RF	8707 ___ 040C1	250	250	250	250	250	250	201	157	157	43	25.9
4 (100) ANSI - 300#, SO / RF	8707 ___ 040C3	276	276	276	276	276	276	201	157	157	43	29.5
6 (150) ANSI - 150#, SO / RF	8707 ___ 060C1	300	300	299	299	300	300	253	185	216	43	32.2
6 (150) ANSI - 300#, SO / RF	8707 ___ 060C3	332	332	331	331	332	332	253	185	216	43	42.2
8 (200) ANSI - 150#, SO / RF	8707 ___ 080C1	350	350	348	351	350	350	303	210	270	43	65.8
8 (200) ANSI - 300#, SO / RF	8707 ___ 080C3	396	396	394	395	396	396	303	210	270	43	73.5
10 (250) ANSI - 150#, SO / RF	8707 ___ 100C1	381	378	375	375	376	381	372	246	324	51	88.5
10 (250) ANSI - 300#, SO / RF	8707 ___ 100C3	435	433	429	429	430	435	372	246	324	51	136.1
12 (300) ANSI - 150#, SO / RF	8707 ___ 120C1	457	455	454	451	452	457	427	274	381	51	149.7
12 (300) ANSI - 300#, SO / RF	8707 ___ 120C3	512	509	508	505	506	512	427	274	381	51	197.3
14 (350) ANSI - 150#, SO / RF	8707 ___ 140C1	531	532	531	528	529	533	481	300	413	51	172.4
14 (350) ANSI - 300#, SO / RF	8707 ___ 140C3	588	589	588	585	586	591	481	300	413	51	259.9
16 (400) ANSI - 150#, SO / RF	8707 ___ 160C1	607	607	606	604	605		532	326	470	80	213.2
16 (400) ANSI - 300#, SO / RF	8707 ___ 160C3	664	664	663	661	662		532	326	470	80	342.5
18 (450) ANSI - 150#, SO / RF	8707 ___ 180C1	682	682	682	679	680		596	358	533	80	268.5
18 (450) ANSI - 300#, SO / RF	8707 ___ 180C3	761	762	761	758	759		596	358	533	80	458.1
20 (500) ANSI - 150#, SO / RF	8707 ___ 200C1	756	757	756	753	754		647	384	584	80	308.4
20 (500) ANSI - 300#, SO / RF	8707 ___ 200C3	839	840	839	836	837		647	384	584	80	535.2
24 (600) ANSI - 150#, SO / RF	8707 ___ 240C1	908	909	911	905	906		763	442	692	80	462.7
24 (600) ANSI - 300#, SO / RF	8707 ___ 240C3	1000	1001	1003	997	998		763	442	692	80	845.9
30 (750) AWWA CLASS D, SO / FF	8707 ___ 300C1	940	941	943	937	938		902	511	857	80	635.0
30 (750) MSS SP44 - 150#, SO / RF	8707 ___ 300C2	1056	1056		1053	1054		902	511	857	80	808.3
30 (750) MSS SP44 - 300#, SO / RF	8707 ___ 300C3	1200	1201		1197	1198		902	511	857	80	1183.9
36 (900) AWWA CLASS D, SO / FF	8707 ___ 360C1	1032	1033	1035	1029	1030		1102	610	1022	80	895.8
36 (900) MSS SP44 - 150#, SO / RF	8707 ___ 360C2	1200	1201		1197	1198		1102	610	1022	80	1259.6
36 (900) MSS SP44 - 300#, SO / RF	8707 ___ 360C3	1351	1351		1347	1348		1102	610	1022	86	1906.9

LINING PROTECTORS  
QUANTITY 2

GROUND RINGS  
QUANTITY 2

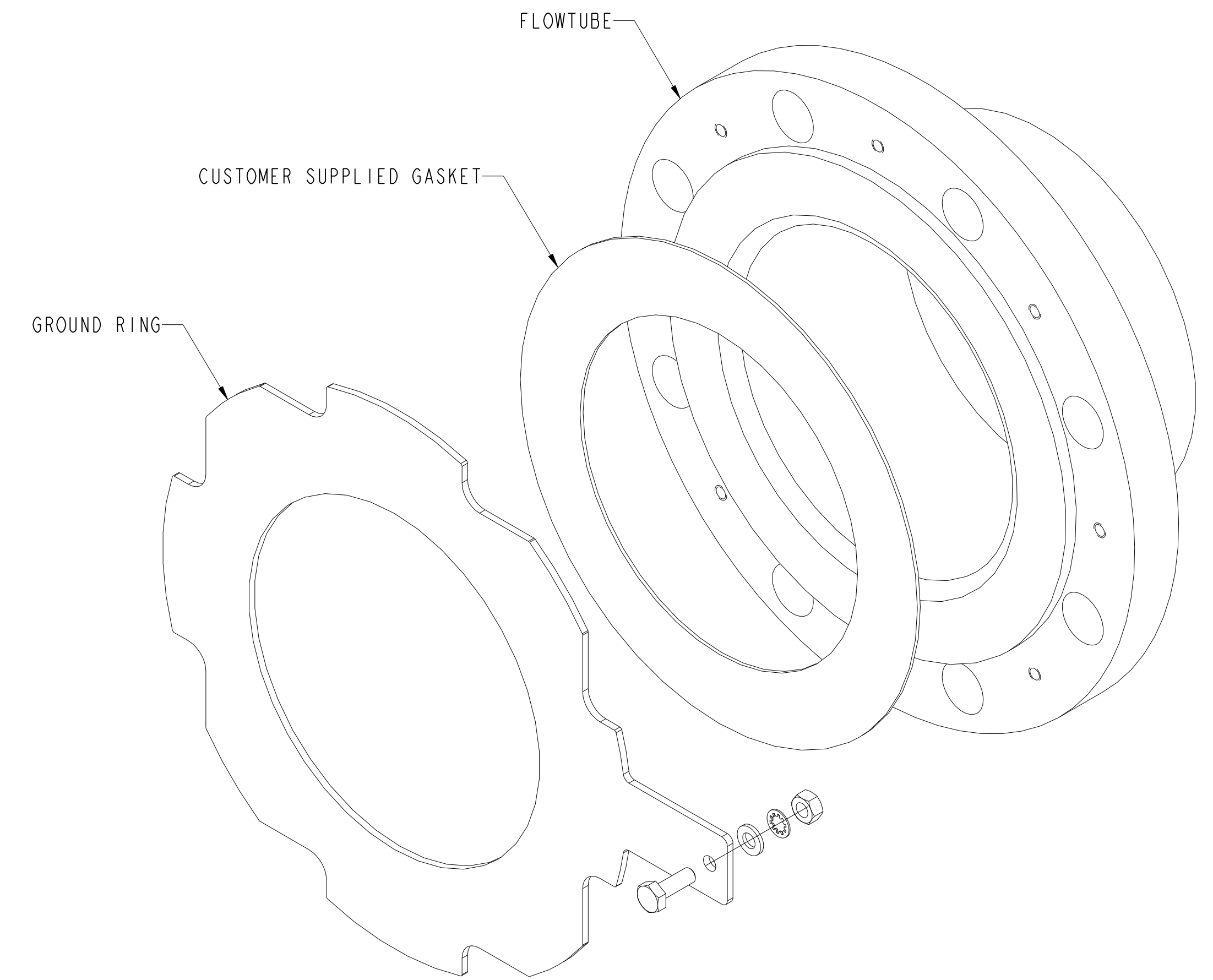
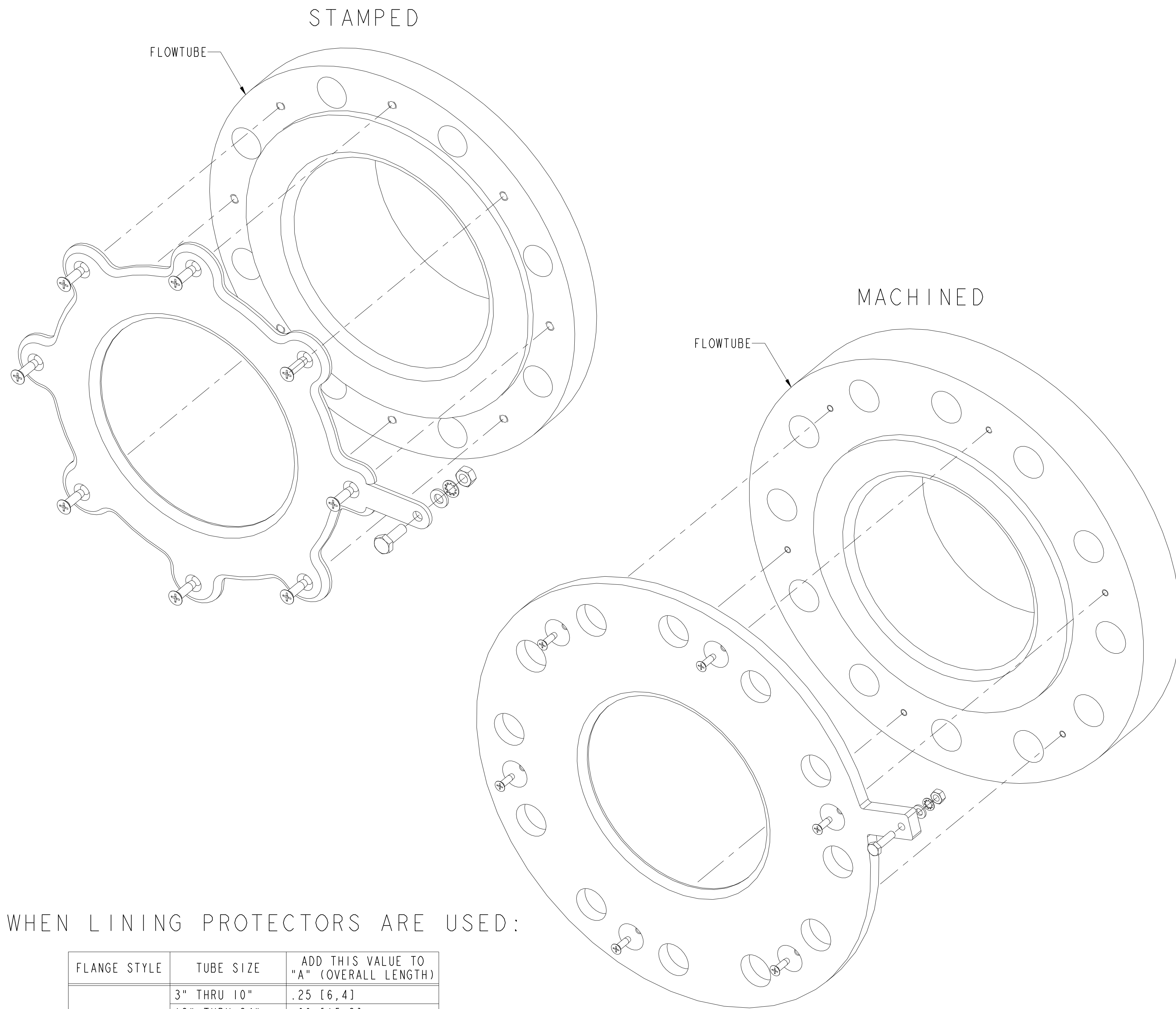

WHEN LINING PROTECTORS ARE USED:

WHEN GROUND RINGS ARE USED:

FLANGE STYLE	TUBE SIZE	ADD THIS VALUE TO "A" (OVERALL LENGTH)
ANSI	3" THRU 10"	.25 [6,4]
	12" THRU 24"	.60 [15,2]
	30"	.75 [19]
	36"	1.0 [25,4]
DIN	3" THRU 8"	.25 [6,4]
	10"	.75 [19]
	12"	1.0 [25,4]
	14" THRU 24"	.60 [15,2]
	30"	.75 [19]
	36"	1.0 [25,4]

ADD .25 [6,4] TO VALUE OF "A" (OVERALL LENGTH)  
FOR ALL SIZES AND FLANGE STYLES